

7846-02
Amd 2

**AMENDMENT NUMBER TWO
TO
AGREEMENT
BETWEEN
THE CITY OF JACKSONVILLE
AND
VT GRIFFIN SERVICES, INC.
FOR
MANAGEMENT AND MAINTENANCE/CARETAKER SUPPORT
AT
CECIL COMMERCE CENTER
(City Contract 7846-02)**

THIS AMENDMENT NUMBER TWO TO AGREEMENT, is made and entered into in duplicate as of this 9 day of July, 2014 by and between the CITY OF JACKSONVILLE, a municipal corporation in Duval County, Florida (hereinafter the "City") and VT GRIFFIN SERVICES, INC., a Georgia corporation authorized to do business in the State of Florida with offices at 5755 Dupree Drive NW, Suite 220, Atlanta, GA 30327 (hereinafter the "Caretaker") for Management and Maintenance/Caretaker Support at Cecil Commerce Center, hereinafter the "Project."

WITNESSETH:

WHEREAS, on August 1, 2013, the City and Caretaker made and entered into an agreement for Management and Maintenance/Caretaker Support at Cecil Commerce Center, City Contract # 7846-02; and

WHEREAS, said Agreement has been amended one time previously; and

WHEREAS, the parties wish to amend said Agreement to increase the maximum indebtedness in Section 3.5 of the Agreement by \$973,467.71 to a new maximum indebtedness amount of \$2,383,395.69, and incorporate the additional "Over and Above" Services and a contract fee for such services as set forth in Exhibit "D" attached hereto and incorporated herein by this reference, with all other provisions, terms and conditions remaining unchanged; and

WHEREAS, said Agreement should be amended as provided herein, now therefore

IN CONSIDERATION of said Agreement and for the mutual covenants herein contained and for other good and valuable consideration, the parties agree that:

1. The above-stated recitals are true and correct and, by this reference, are incorporated herein and made a part hereof.

2. Section 3, Subsection 3.1.2 of said Agreement is amended, in part, to read as follows:

3.1.2 For “Over and Above Services” as described in Section 1.7 hereof, an amount not-to-exceed TWO HUNDRED SEVENTY THOUSAND EIGHTEEN AND 98/100 DOLLARS (\$1,243,486.69).

4. Section 3.5 of said Agreement is amended to increase the total maximum indebtedness, and as amended, shall read as follows:

“3.5 Based on the initial proposal and work plan negotiated and the “Over and Above Services” described on Exhibits “C” and “D” attached hereto, the maximum indebtedness of the CITY for all services and reimbursables pursuant to this Agreement shall not exceed the sum of TWO MILLION THREE HUNDRED EIGHTY-THREE THOUSAND THREE HUNDRED NINETY-FIVE and 69/100 Dollars (\$2,383,395.69). This amount may be increased based on increased maintenance requirements at Cecil Commerce Center by Bi-lateral agreement of the parties upon execution of an amendment to this Agreement specifically increasing the City’s maximum indebtedness.”

5. Said Agreement is amended, in part, by adding and incorporating therein a Scope of Service and Contract Fee form as Exhibit “D.”

6. Attach Exhibit “D” to said Agreement.

SAVE AND EXCEPT as expressly amended herein and in prior amendments to the Agreement, the terms and conditions of the Agreement of August 1, 2013, remain in full force and effect.

[Remainder of page left blank intentionally. Signature page follows immediately.]

IN WITNESS WHEREOF, the parties hereto have duly executed this instrument the day and year first above written.

ATTEST:

By: James R. McCain, Jr.
James R. McCain, Jr.
Corporation Secretary



CITY OF JACKSONVILLE

By: Karen Bowling
Alvin Brown, Mayor
Karen Bowling
Chief Administrative Officer
For: Mayor Alvin Brown
Under Authority of:
Executive Order No. 2013-04

WITNESS:

By: Gary J. Sutton
Print Name: Gary J. Sutton

V.T. GRIFFIN SERVICES, INC.

By: James D. Jelsora
Print Name: James D. Jelsora
Title: PM VT-Group

Form Approved:

[Signature]
Office of General Counsel

In accordance with Section 24.103(e), of the *Ordinance Code* of the City of Jacksonville, I do hereby certify that there is an unexpended, unencumbered and unimpounded balance in the appropriation sufficient to cover the foregoing agreement, and provision has been made for the payment of the monies provided therein to be paid.

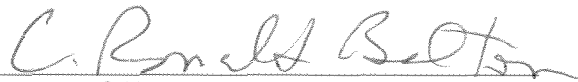

Director of Finance

City Contract 7846 -02 Amd #2



Exhibit D

CITY OF JACKSONVILLE NOTES

GENERAL
 All construction shall be performed in accordance with the approved plans and comply with all standards, rules, policies, and practices. City engineers will not perform any required state or federal permit approvals, such as those from the Department of Environmental Protection or the FL Army Water State Management Division (SWMMMS).

UTILITY WORK
 Plan approval through Engineering Services does not include electric, telephone, water, or electric meterwork. These items must be approved separately through the respective utility companies. In most cases, this will be:
 EA
 EA Town - 4th Floor, 27 N. Church Street, Jacksonville, FL 32202
 910.255.4022

WORK WITHIN THE RIGHT-OF-WAY
 CITY: Except for new subdivision infrastructure construction, all work performed within a City of Jacksonville right-of-way or easement requires a Right-of-Way Permit. The contractor performing the proposed work must have a current Right-of-Way Standing with Development Services. Right-of-Way Permit applications are processed at:
 Development Services Customer Service Counter
 City Hall Building, 2nd Floor
 214 N. Hogan St.
 Jacksonville, FL 32202
 (904) 255-4022
 http://www.jacksonville.net

STATE: All work performed within a state right-of-way requires a permit from the Florida Department of Transportation (FDOT). It is the developer's responsibility to obtain required FDOT permits or modifications of existing approvals for work within FDOT right-of-way. The FDOT regional office can be contacted at (888) 368-6200. Any changes to the approved plans needed for FDOT approval must be submitted to Development Services in a revision.

ADJACENT STATE RIGHTS:
 RAILROAD: Railroad companies may require special approvals or permits to work within their right-of-ways. It is the developer's responsibility to obtain permission from any railroad right-of-way owner before performing any work within their right-of-way.

STORMWATER
 Annual reports in compliance with the SURFWQ stormwater controls are required from the responsible entity of all stormwater management facilities. Send copies of the reports to:
 Engineering and Construction Management
 Evans Building, 10th Floor
 214 N. Hogan St.
 Jacksonville, FL 32202
 http://www.cityofjacksonville.com/development-services-and-construction-management
 The owner of any project one (1) acre or larger is required to provide a Notice of Intent (NOI) in accordance with criteria set forth in the city's NPDES permit within 48 hours of beginning construction. Send NOI and NOI fee to:
 Florida Department of Environmental Protection
 NPDES Compliance Section Mail Stop 30219
 2600 New Smyrna Road
 Lake Wales, Florida 33853-3400
 (888) 338-6342
 http://www.dep.state.fl.us/water/npdes.html
 The contractor shall contact City Environmental Quality Division before beginning construction.
 Environmental Quality Division
 417 North Loop Street, Third Floor
 Jacksonville, FL 32202
 (904) 336-7224

FIRE MARSHALL
 Plan review and approval does not relieve the contractor of complying with all applicable State Fire Codes.
 Underground mains and hydrants shall be installed, completed, and in service prior to construction work.
 Underground contractor shall submit to the Fire Marshall for approval complete specs for all underground pipe and fittings relating to the protection (PFR) to installation and installation. Contractor shall include manufacturer's name and pipe ID along with contractor's state license number.

LANDSCAPE
 A Site Work Permit is required for this project.
 Tree Fund payment is due: _____ inches at \$ _____ = \$ _____
 Article 25 funds are due: _____ inches at \$ _____ = \$ _____

TRAFFIC ENGINEERING
TRAFFIC SIGNS

Minor Signs	_____	\$100.00	ea.	_____
Standard	_____	\$100.00	ea.	_____
Street Signs	_____	\$75.00	ea.	_____
Design	_____	\$45.00	ea.	_____
Installation	_____	\$45.00	hr.	_____
TOTAL _____				

Streetlights Required

NOTE: Traffic sign costs change from three to two, if the costs change after plan approval but prior to payment for installation, the developer must pay for the signs at the current costs. The above total assumes the subdivision will be platting as one phase. If the development is platting as separate phases, design and installation will be calculated separately for each phase.
 No lane closures allowed from 7 a.m. to 8 a.m. and from 4 p.m. to 5 p.m.

ADVANCED CLEARING, GRUBBING AND GRADING PLANS

N1/N2 ENTRANCE ROAD AT CECIL COMMERCE CENTER PREPARED FOR CITY OF JACKSONVILLE DUVAL COUNTY, FLORIDA MAYOR: ALVIN BROWN COJ ENGINEERING: WILLIAM J. JOYCE, P.E.

214 NORTH HOGAN STREET
 JACKSONVILLE, FLORIDA 32202



England-Thim & Miller, Inc.
 14775 Old St. Augustine Road
 Jacksonville, FL 32258
 TEL: (904) 642-8990
 FAX: (904) 646-9485
 CA - 00002584 LC - 0009316

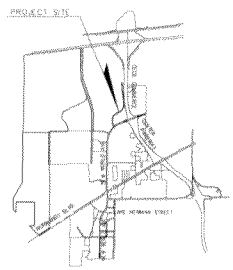

LOCATION MAP
 N-1-5

Drawing List

Sheet Number	Sheet Title
1	COVER SHEET
2	GENERAL NOTES AND LEGEND
3	TYPICAL SECTION
4 - 10	PLAN & PROFILE SHEETS
11 - 21	CROSS SECTION SHEETS
22	STORMWATER QUALITY PROTECTION AND PREVENTION PLAN
23 - 24	SEDIMENT AND EROSION CONTROL DETAILS

GENERAL PROJECT INFORMATION

GENERAL	
City Development Number	09302-2383
Community Approval Number	000883-0000
Property Approval Number (if F)	_____
Zoning Description	_____
Plan Approval Number	17-13847
File - Community - Plan	10002-0422
Home Zones (Show in Plans)	_____
Base Flood Elev. (Show in Plans)	_____
Vehicle Return Level for Project	100.00
4 - Availability Number	0000
SUBDIVISION	
PD Number	_____
City or Private Inspection	_____
Public or Private Report	_____
Subdivision ("B") Date Proposed	_____
NOTE: SUB-DIVISION	
North American Industry Classification System (NAICS)	23210
International Area Code (I.C.)	330

PLAN APPROVAL

Date: _____ (Developer) Services Division (Date)

Date: _____ (City) _____ (Reviewer)

Plan approval is valid for five years after the initial approval date. Revisions made after the initial approval date do not extend this five-year time frame.

COVER SHEET
 N1/N2
 AT
 CECIL COMMERCE CENTER
 ENGINEERING NUMBER
 1
 DATE: 07/22/14
 TIME: 3:28:31 PM
 PROJECT: 17-13847
 DRAWING: 1-1
 DRAWN BY: JF
 CHECKED BY: JF
 DESIGNED BY: JF
 DATE: 07/22/14
 ENGINEER: WILLIAM J. JOYCE, P.E.
 LICENSE NO. 17000
 FIRM: ETM
 FIRM LICENSE NO. 17000
 FIRM ADDRESS: 14775 OLD ST. AUGUSTINE ROAD, JACKSONVILLE, FL 32258

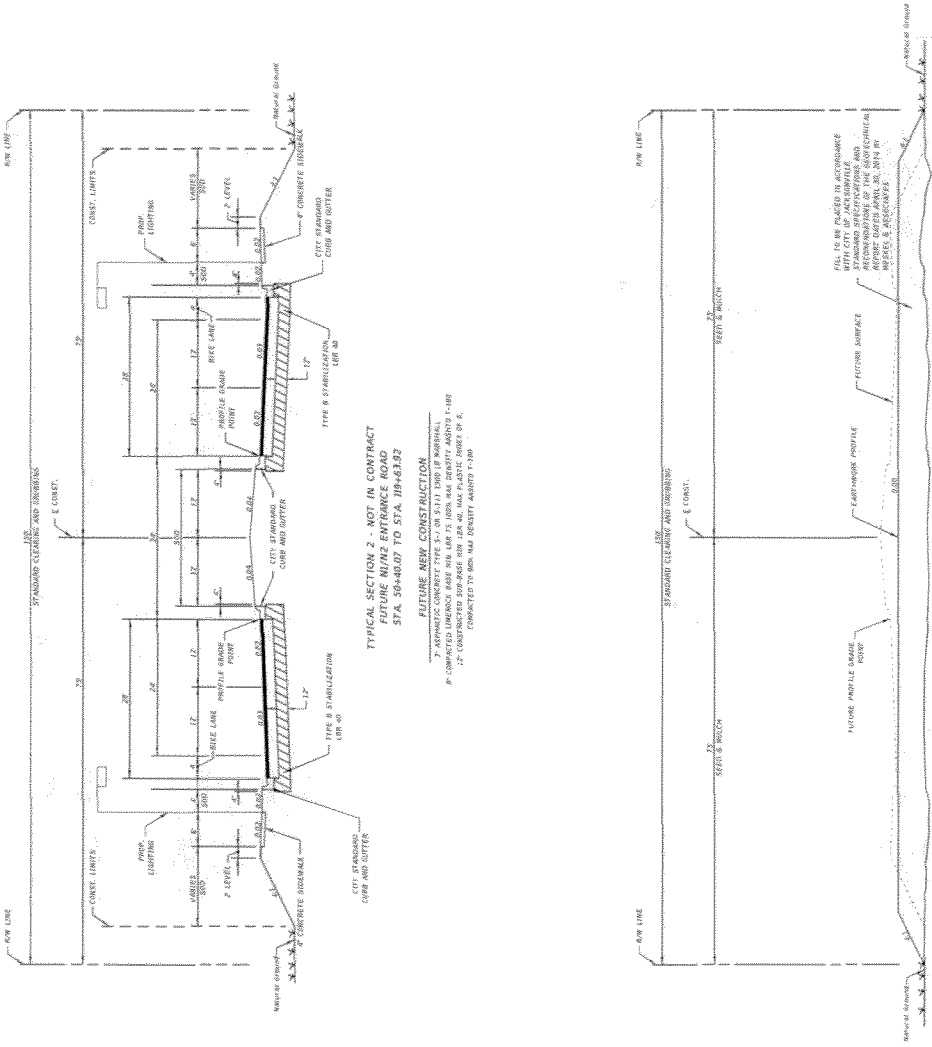

TYPICAL SECTION 2 - NOT IN CONTRACT
FUTURE NINIZ ENTRANCE ROAD
STA. 304+0.07 TO STA. 10+63.92

FUTURE NEW CONSTRUCTION
7" ASPHALT CONCRETE TYPE S-1 OR S-111 DOW (P) BARS
P-COMPACTED UNBLENDED 1.5" 100% RAG DENSITY AGGREGATE 1-HP
12" COMPACTED TO 98% RAG DENSITY AGGREGATE 1-HP
COMPACTED TO 98% RAG DENSITY AGGREGATE 1-HP

TYPICAL SECTION 1
NINIZ ENTRANCE ROAD
STA. 304+0.07 TO STA. 10+63.92

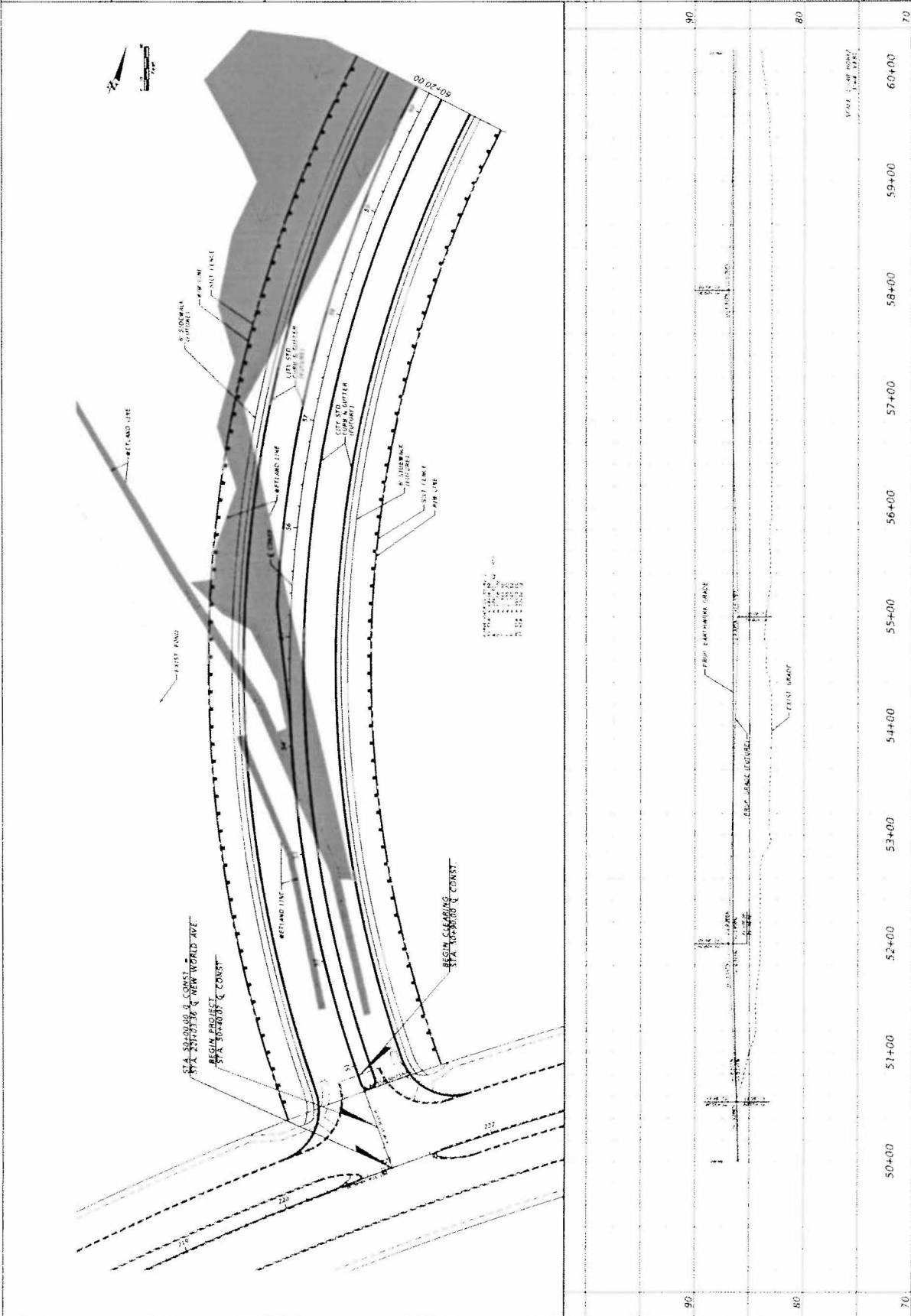

5

PLAN & PROFILE SHEET
 AT
 N1/2
 CECIL COMMERCE CENTER



ETM
 ENGINEERING & TECHNICAL SERVICES, INC.
 10000 W. 10th Avenue, Suite 100
 Golden, CO 80401
 (303) 440-1000
 www.etm-engineering.com

DATE	DESCRIPTION
05/12/2014	ISSUE FOR PERMIT
05/12/2014	ISSUE FOR PERMIT
05/12/2014	ISSUE FOR PERMIT
05/12/2014	ISSUE FOR PERMIT
05/12/2014	ISSUE FOR PERMIT

PROJECT NO. 14-001
 SHEET NO. 5
 DATE: 05/12/2014
 TIME: 1:28:58 PM
 BY: ETM

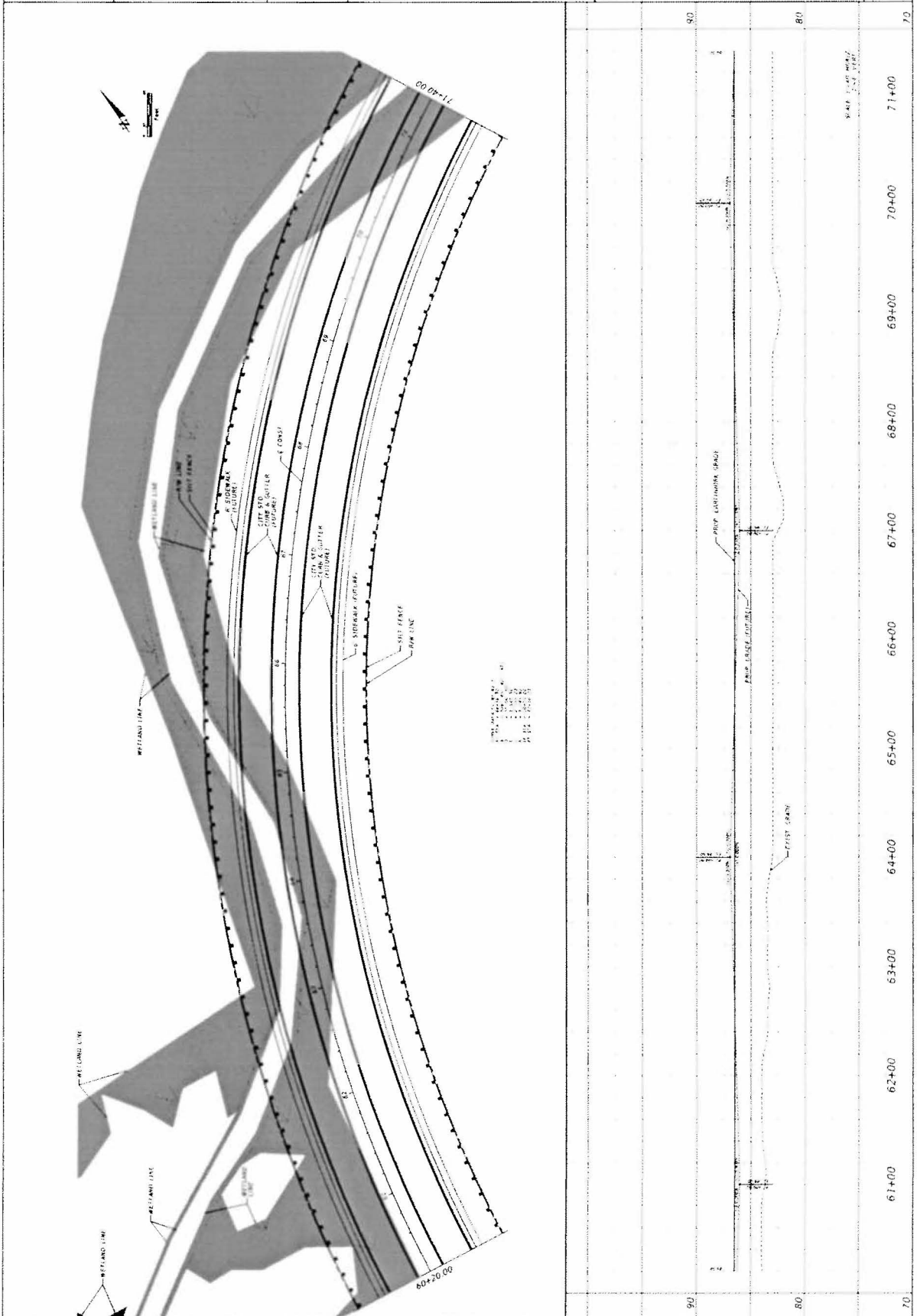

PLAN & PROFILE SHEET
N1/N2
AT
CECIL COMMERCE CENTER



Engineering, Planning, & Survey, Inc.
14775 Old Highway Road
Aurora, Illinois 60018
Tel: 630-584-8800
Fax: 630-584-8801
CA: 00000000-00000000

DATE	01/27/2014
PROJECT	CECIL COMMERCE CENTER
SCALE	AS SHOWN
DESIGNER	CECIL COMMERCE CENTER
CHECKER	CECIL COMMERCE CENTER
APPROVER	CECIL COMMERCE CENTER
DATE	01/27/2014

PROJECT NO. 14775
DATE: 01/27/2014
TIME: 3:27:00 PM
BY: JLM

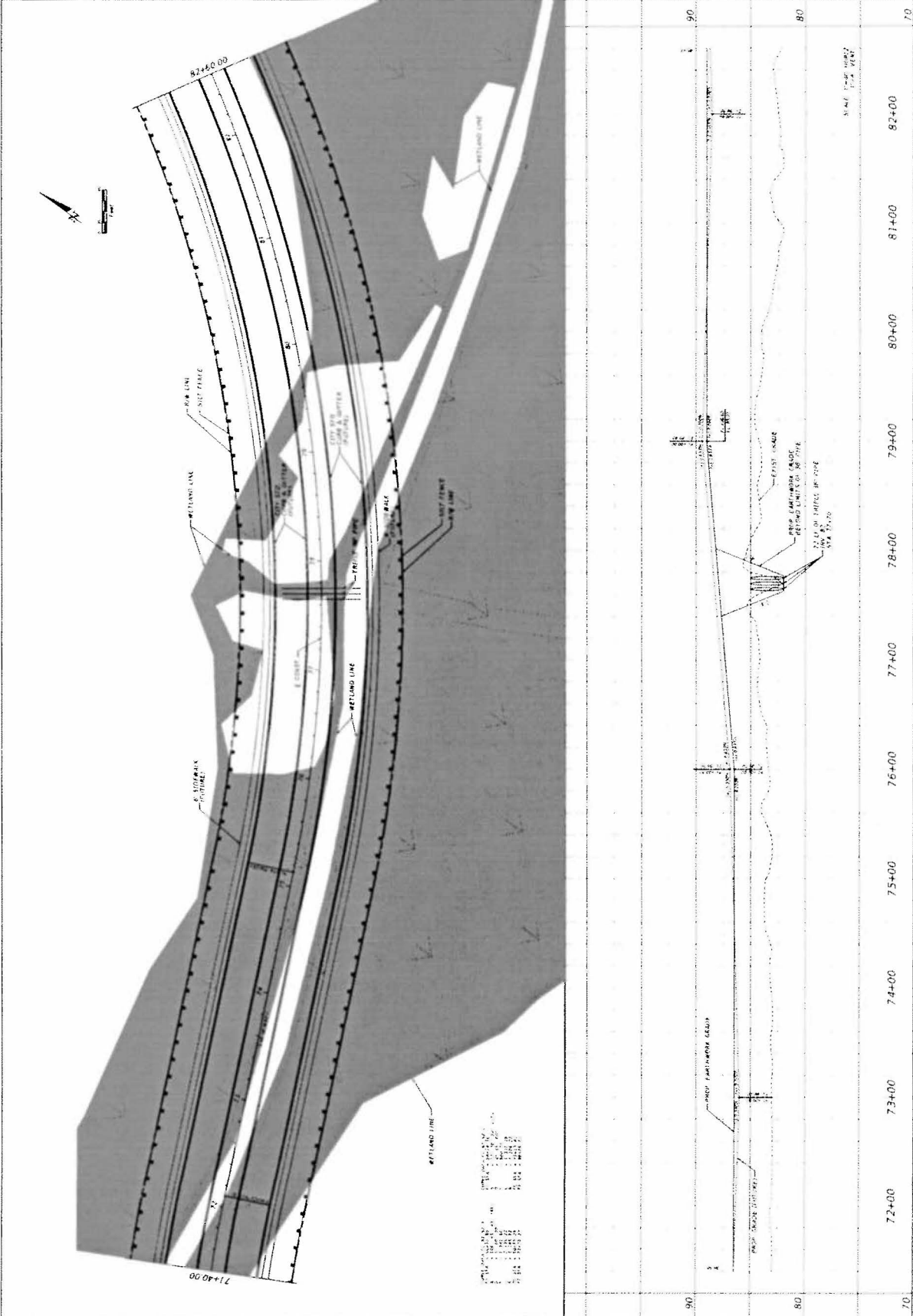

DATE	5/17/2014
PROJECT	116+00 TO 119+00
CLIENT	116+00 TO 119+00
SCALE	AS SHOWN
DRAWN BY	Y.H.
CHECKED BY	Y.H.
DATE	5/17/2014
REVISIONS	
NO.	DESCRIPTION
1	ISSUED FOR PERMIT
2	REVISED FOR COMMENTS
3	REVISED FOR COMMENTS
4	REVISED FOR COMMENTS
5	REVISED FOR COMMENTS
6	REVISED FOR COMMENTS
7	REVISED FOR COMMENTS
8	REVISED FOR COMMENTS
9	REVISED FOR COMMENTS
10	REVISED FOR COMMENTS

105+00 106+00 107+00 108+00 109+00 110+00 111+00 112+00 113+00 114+00 115+00 116+00 116+20.00

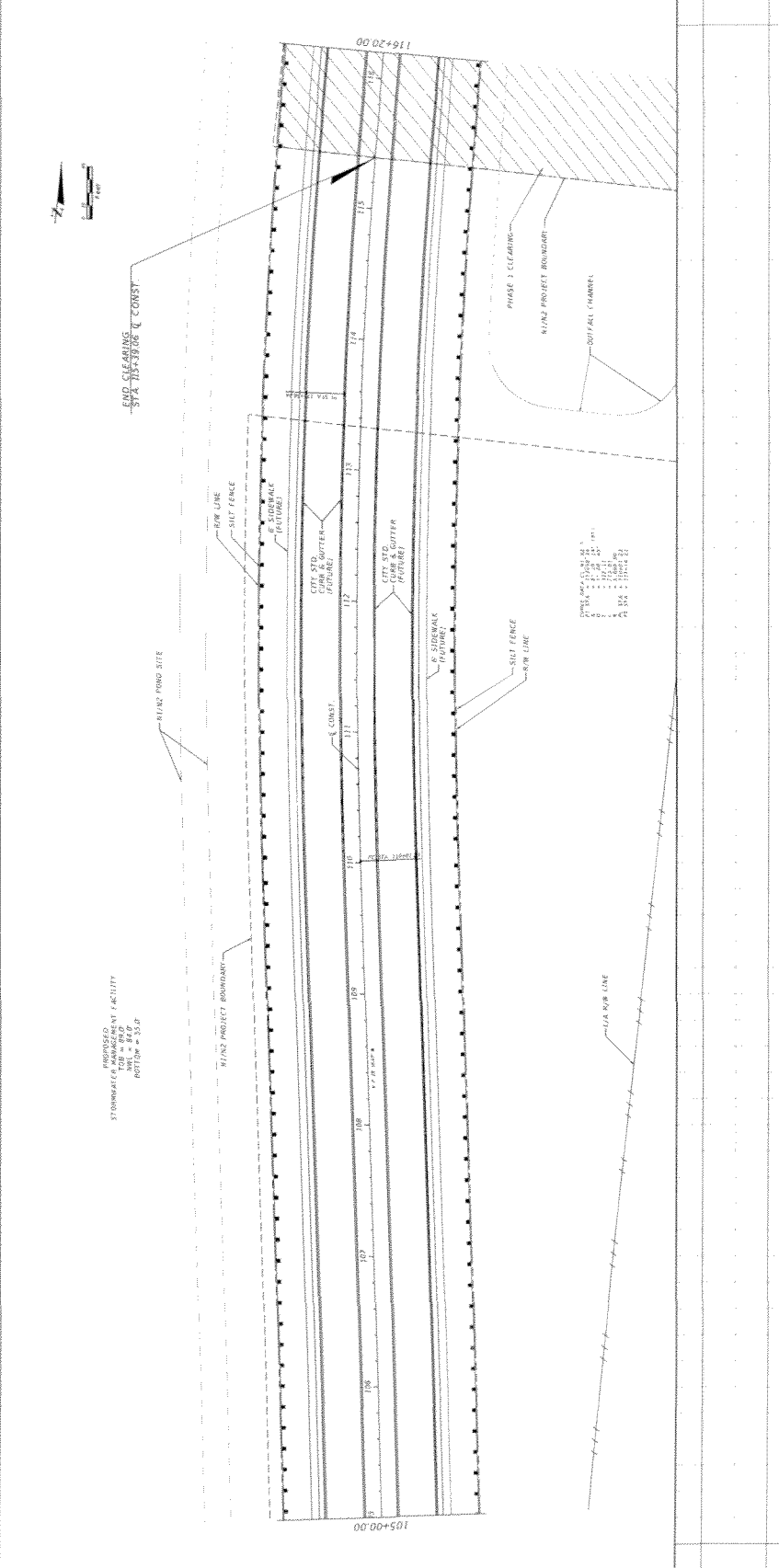
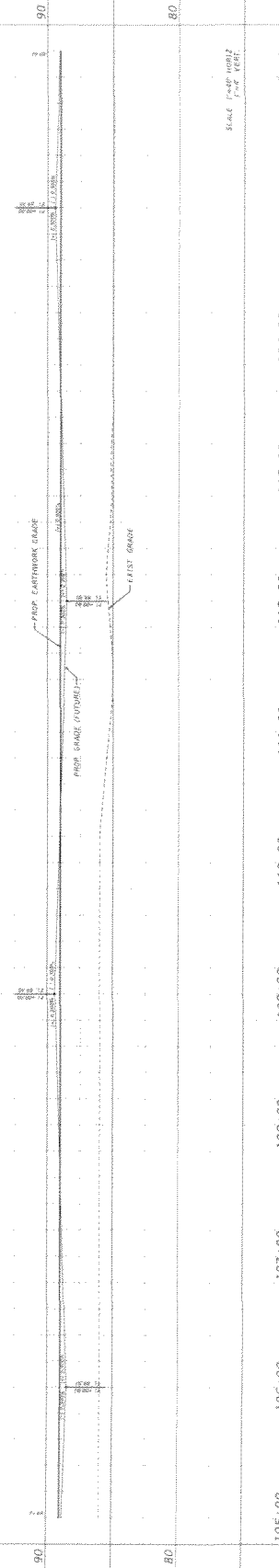

PLAN & PROFILE SHEET
 AT
 N1N2
 CECIL COMMERCE CENTER

10
 DRAWING NUMBER

DATE: 9/7/2014
 CHECKED BY: BM
 DESIGNED BY: JM
 DRAWN BY: CP
 PROJECT NO.: 14-0210
 SHEET NO.: 10

ETM
 EMPLOYMENT, TRADING & INVESTMENT INC.
 4475 SW 8th Avenue
 Mableton, GA 30126
 PHONE: (770) 573-9500
 FAX: (770) 573-9501
 CA - (303) 441-7200
 VISION • EXPERIENCE • RESULTS

5-12-147-12-10-01-25-n1n2-cecilcommerccenter.dwg (10/10)

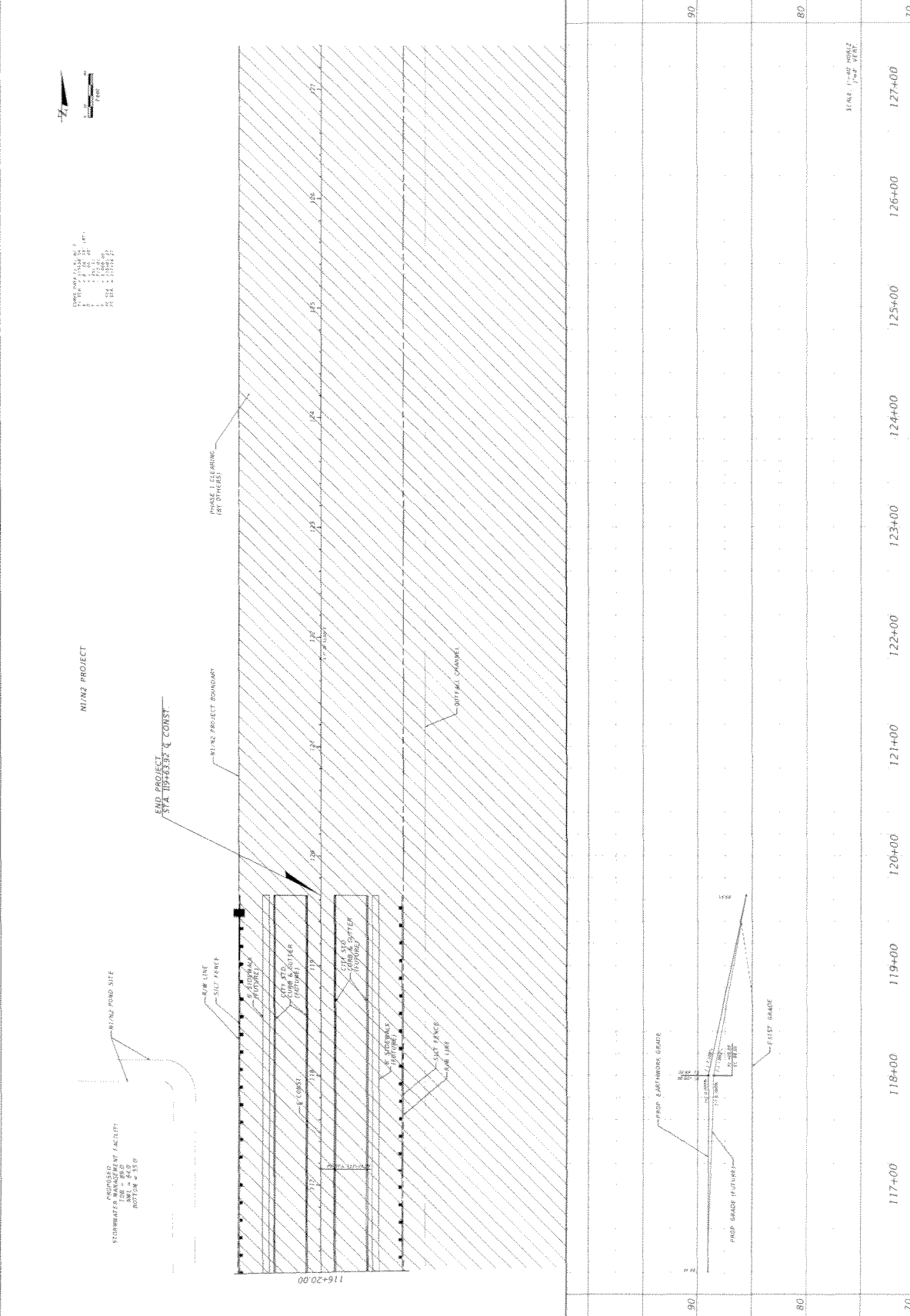

CONC. DIM. (IN FEET)

10
11
12
13
14
15
16
17
18
19
20

116+20.00	117+00	118+00	119+00	120+00	121+00	122+00	123+00	124+00	125+00	126+00	127+00
-----------	--------	--------	--------	--------	--------	--------	--------	--------	--------	--------	--------

CROSS SECTIONS
AT
N1/N2
CECIL COMMERCE CENTER



ETM
ETM Engineering & Technology, Inc.
14775 Old St. Augustine Road
Anniston, AL 36810
256-836-8888
CA - 1000461 LC - 07879174

MODEL: Bldg1.dwg
DATE: 5/7/2014
DRAWN BY: JAC
CHECKED BY: JAC
DESIGNED BY: JAC
SCALE: 1/8" = 1'-0"
BY: JAC

PROJECT: 5/17/2014 3:27:06 PM
DRAWN BY: JAC
CHECKED BY: JAC
DESIGNED BY: JAC
SCALE: 1/8" = 1'-0"
BY: JAC

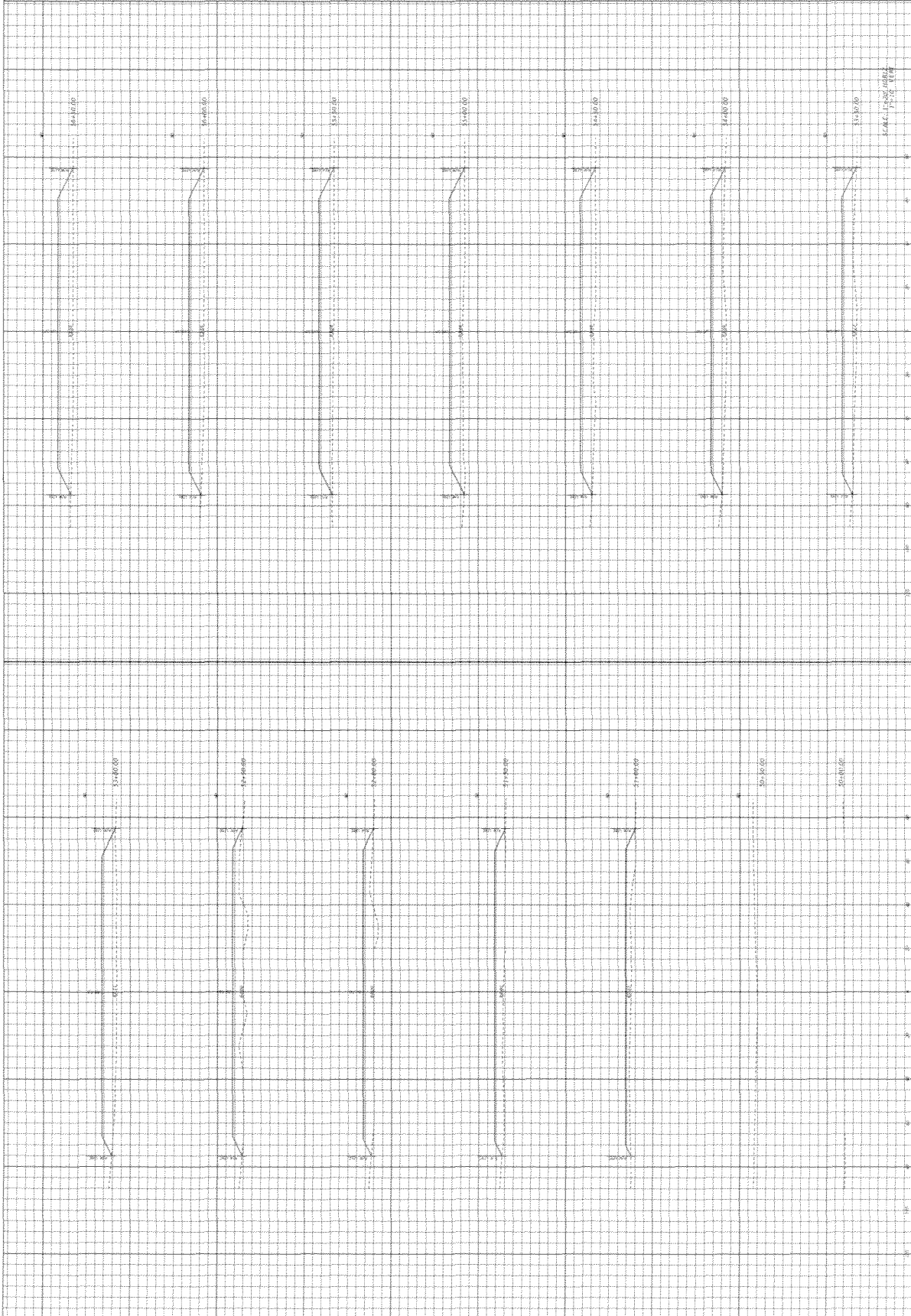

SECTION NUMBER

CROSS SECTIONS
N1/N2
AT
CECIL COMMERCE CENTER



Ernst & Young
1111 Market Street, Suite 1200
San Francisco, CA 94102
Tel: 415.774.4000
www.ey.com

PROJECT: N1/N2 CROSS SECTIONS
DATE: 01/27/2014
DRAWN BY: JG
CHECKED BY: JG
SCALE: 1/4" = 1'-0"

MOORE
REVISED 01/27/2014
PLOTTED 01/27/2014 10:27:03 AM
BY: jg@ey.com

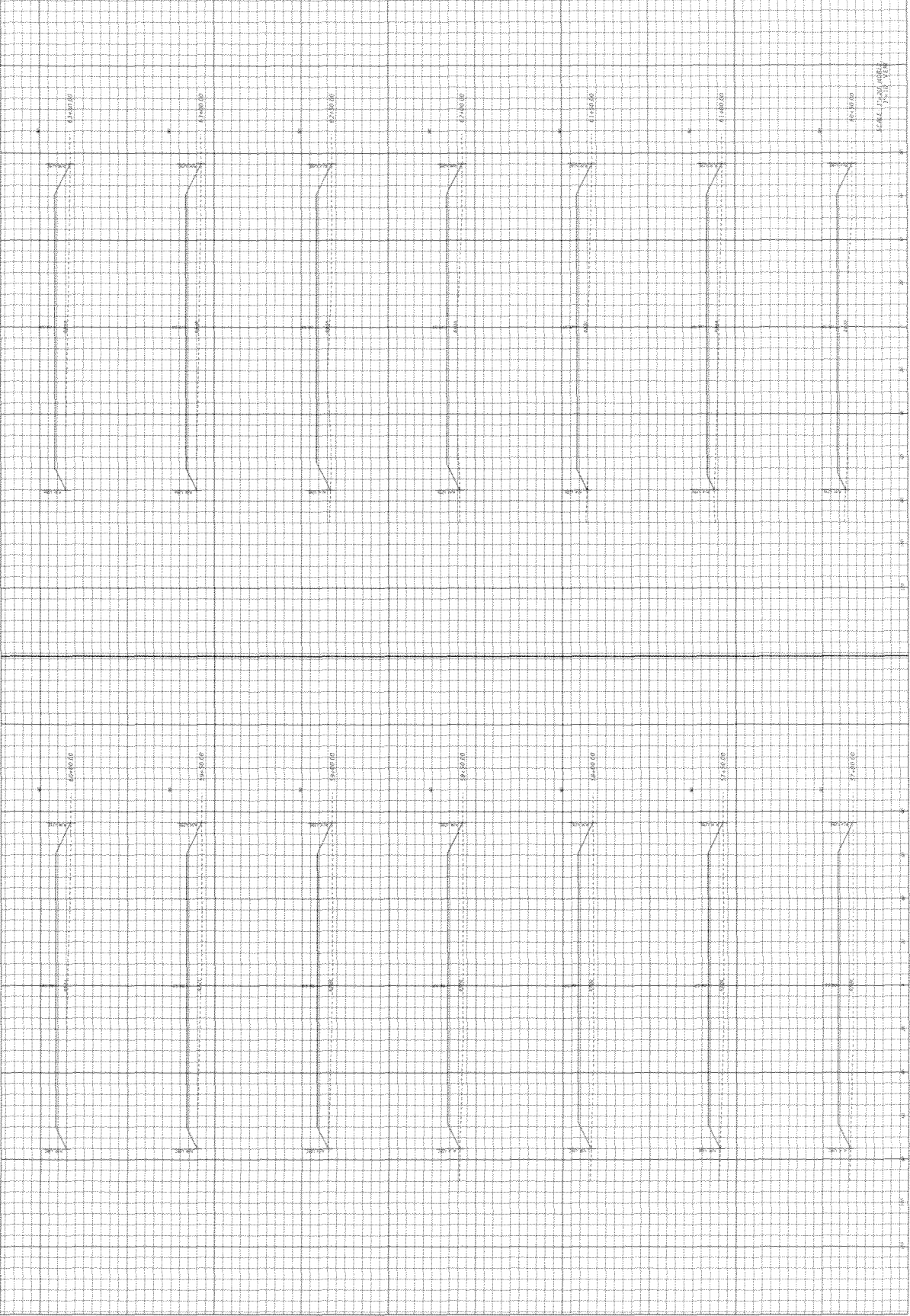

CROSS SECTIONS
AT
N1/2
CECIL COMMERCE CENTER



Englund, Hays & ITT Inc., Inc.
4070 Old Republic Road
Manassas, VA 20108
703-790-8888
Fax: 703-790-8889
CA - 0098641 LC - 0098641

MODEL: RdCross.dwg
DATE: 5/17/14
DRAWN BY: JAC
CHECKED BY: JAC
SCALE: 1" = 10'-0"

REVISIONS:
NO. DATE BY
1 12/18/13 JAC
2 1/27/14 JAC
3 5/17/14 JAC
PROJECT: PLOT15.D, 5/17/2014 3:27:07 PM
BY: jf@etm.com
LACON WORKS P.C.
16053
10000 WOODBURN LANE, CH
DUBLIN, CA 94568

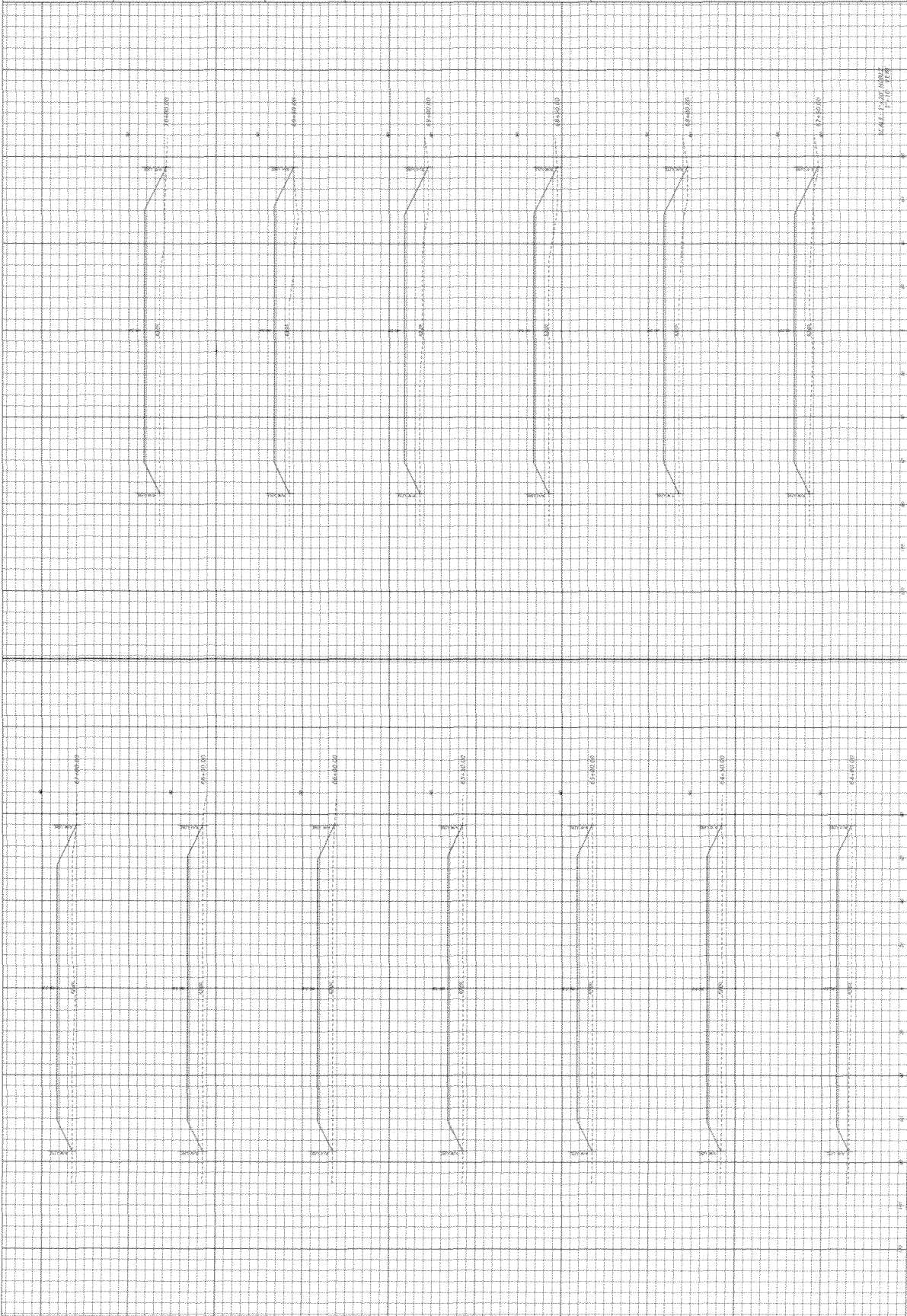

CROSS SECTIONS
AT
N1/N2
CECIL COMMERCE CENTER



ETM
Engineering, Technology & Management, Inc.
10000 N. 15th Street
Suite 100
Tomball, TX 77375
713.281.1100
www.etm.com

DATE: 5/17/2014
PROJECT: 14-00000
JOB NO.: 14-00000
JOB NAME: CECIL COMMERCE CENTER

MODEL: RD+ST.DWG
PLOT FILE: 14-00000-01.dwg
PLOT DATE: 5/17/2014 3:27:02 PM
PLOT SCALE: 1/8"=1'-0"

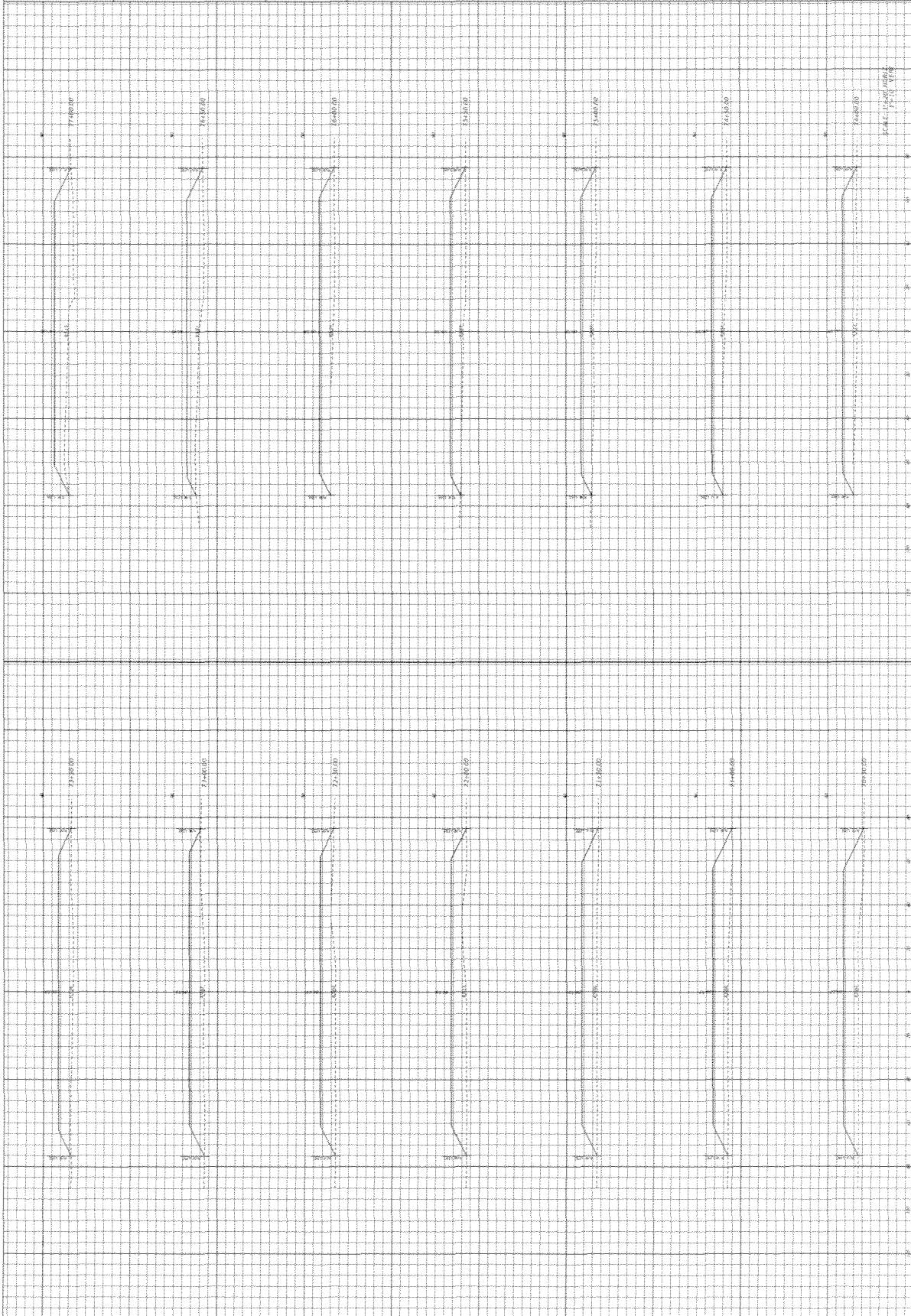

CROSS SECTIONS
 AT
 CECIL COMMERCE CENTER



ETM
 Eminent, Tang & Tiller, Inc.
 1000 SOUTH
 WASHINGTON ST.
 SUITE 200
 ANN ARBOR, MI 48106
 TEL: 734.769.1000
 FAX: 734.769.1001
 WWW.ETM-INC.COM

MODEL: 8434.dwg
 DATE: 3/1/2014
 DRAWN BY: JMM
 CHECKED BY: JMM
 DESIGNED BY: JMM
 SCALE: 1" = 10'-0"

PROJECT: 5112/2014
 DATE: 3/27/14
 BY: JMM
 JASON WICKS, P.E.
 11000 WOODLAND DRIVE
 ANN ARBOR, MI 48106
 TEL: 734.769.1000
 FAX: 734.769.1001
 WWW.ETM-INC.COM

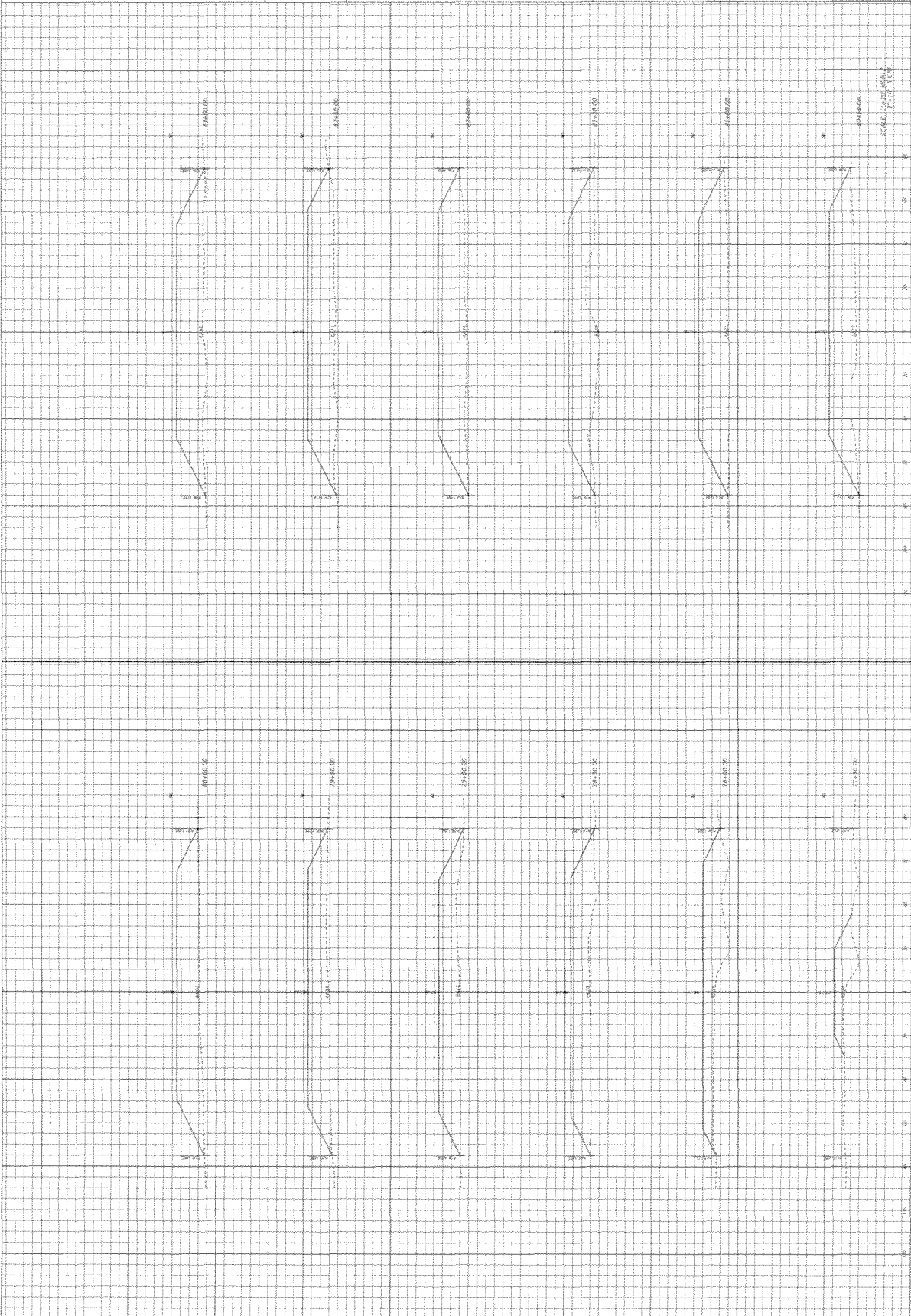

CROSS SECTIONS
AT
N1+N2
CECIL COMMERCE CENTER



ETM ENGINEERING, DESIGN & CONSTRUCTION, INC.
4413 98th Ave. S., Suite 200
Fargo, ND 58103
701.785.8888
CA - LICENSE LC-2025000001

MODEL: Bldg1.dwg
DATE: 9/7/2014
DRAWN BY: JAC
CHECKED BY: JAC
SCALE: AS SHOWN

PROJECT: 15172014 3/7/07 BH
DATE: 9/7/2014
DRAWN BY: JAC
CHECKED BY: JAC
SCALE: AS SHOWN

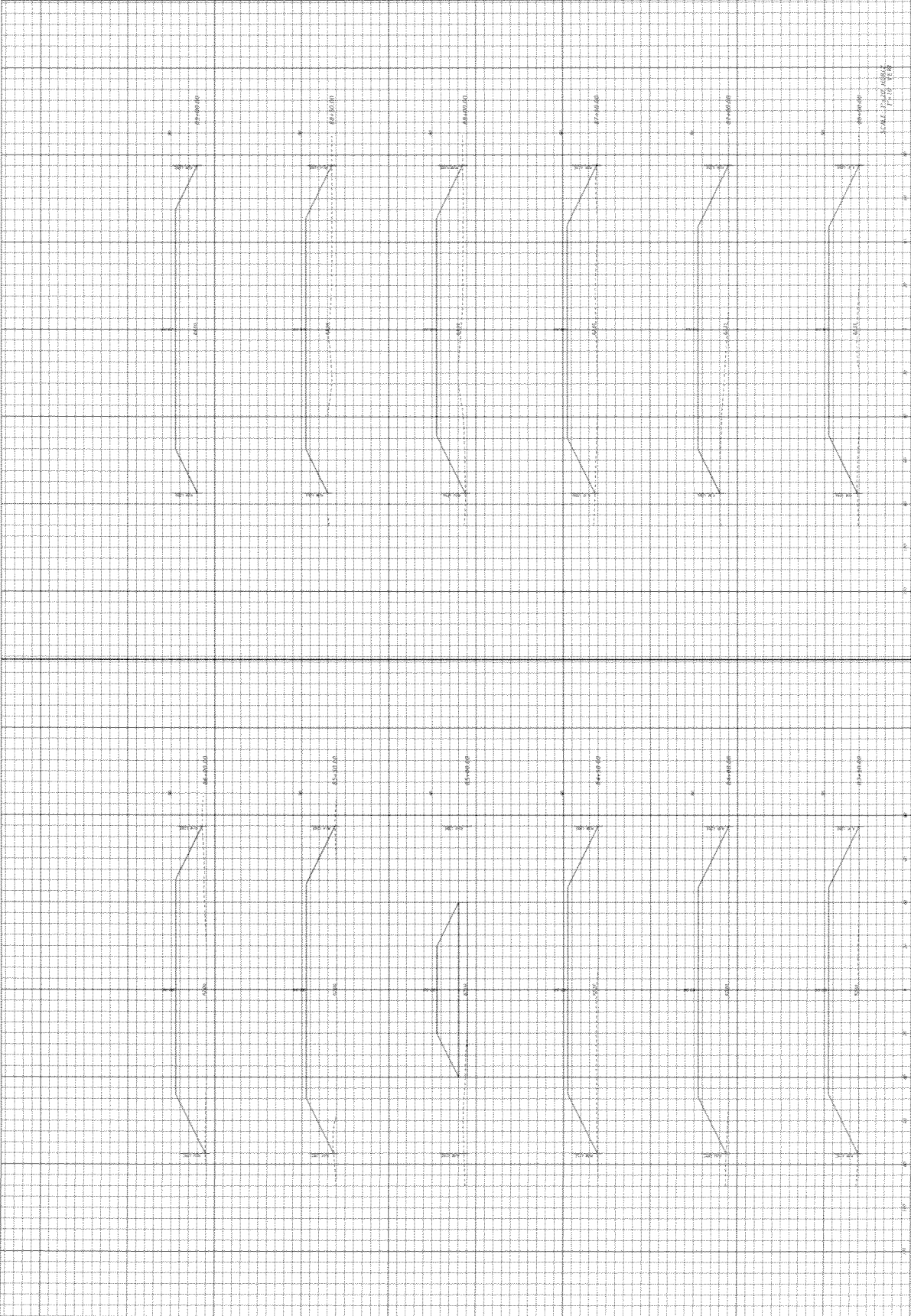

SCALE: 1/4" = 1'-0"

CROSS SECTIONS AT N1N2 CECIL COMMERCE CENTER



ETM
Engr. Thoms & Thoms, Inc.
1000 N. 1st St., Suite 100
Jennings, LA 70501
Tel: 225-966-1111
Fax: 225-966-1112
CA 1000000100-00000000

DATE	3/1/2014
DESIGNED BY	RM
CHECKED BY	JM
SCALE	AS SHOWN
PROJECT NO.	1000000100-00000000

MODEL: Rd1414.dwg
 PLOTTED: 5/12/2014 3:27:08 PM
 BY: dmh
 JASON WILSON
 1000000100-00000000
 PROJECT NO.
 SCALE: AS SHOWN
 CHECKED BY: JM
 DESIGNED BY: RM

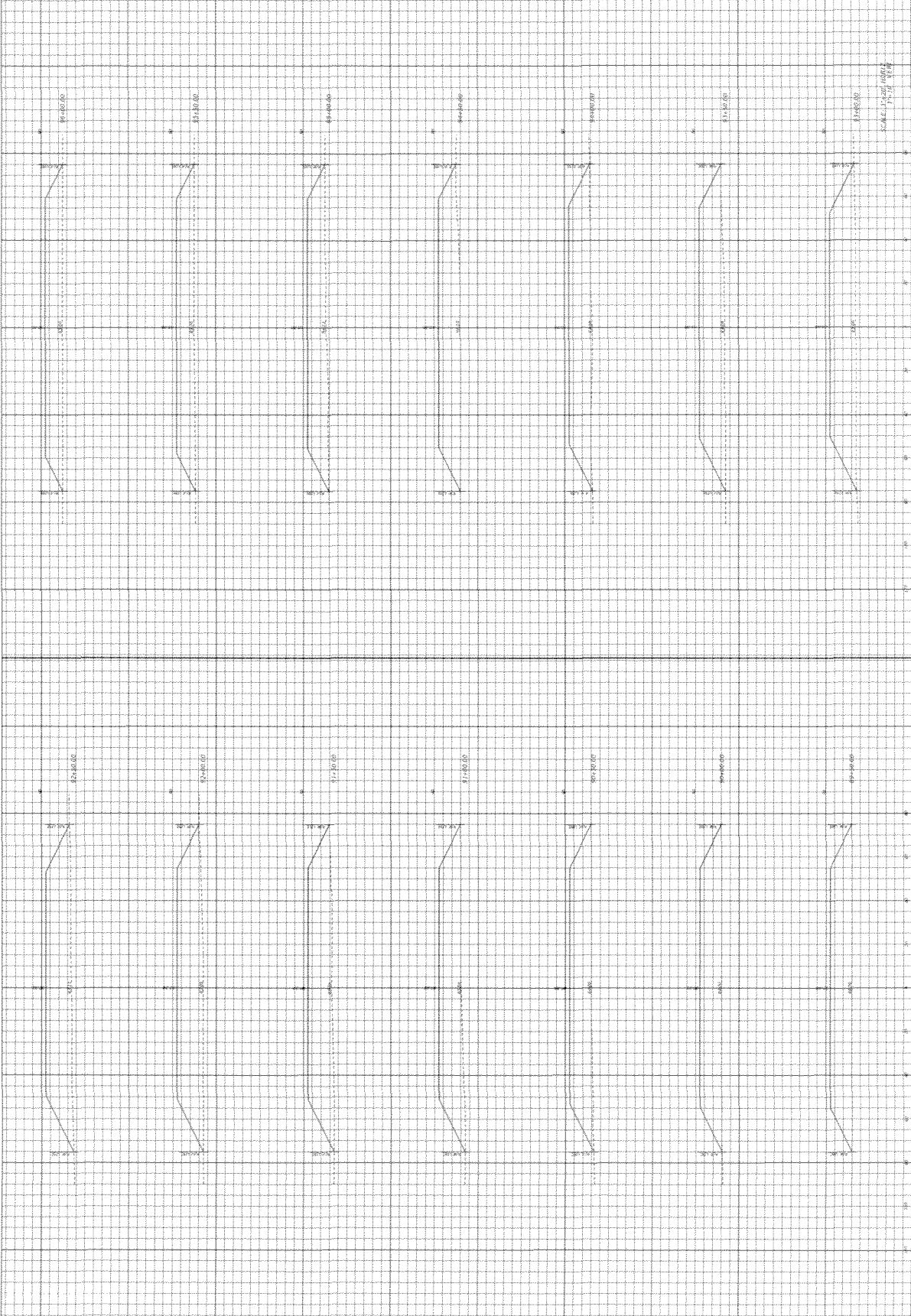

CROSS SECTIONS
AT
N1/N2
CECIL COMMERCE CENTER



VISION • EXPERIENCE • RESULTS
ETM ENGINEERING & TECHNOLOGY, INC.
10000 W. 10th Street, Suite 100
Denver, CO 80202
Phone: 303.751.1100
Fax: 303.751.1101
www.etm-engineering.com

DATE	5/27/2014
DESIGNED BY	AM
CHECKED BY	AM
DRAWN BY	CP
SCALE	AS SHOWN

MODEL: Rkx5rd.dwg
 PLOTTED: 5/12/2014 1:27:08 PM
 BY: pfehl
 PLOT SCALE: 1"=10'-0"
 PLOT AREA: 11.00 x 17.00
 PLOT DEVICE: HP DesignJet 5000

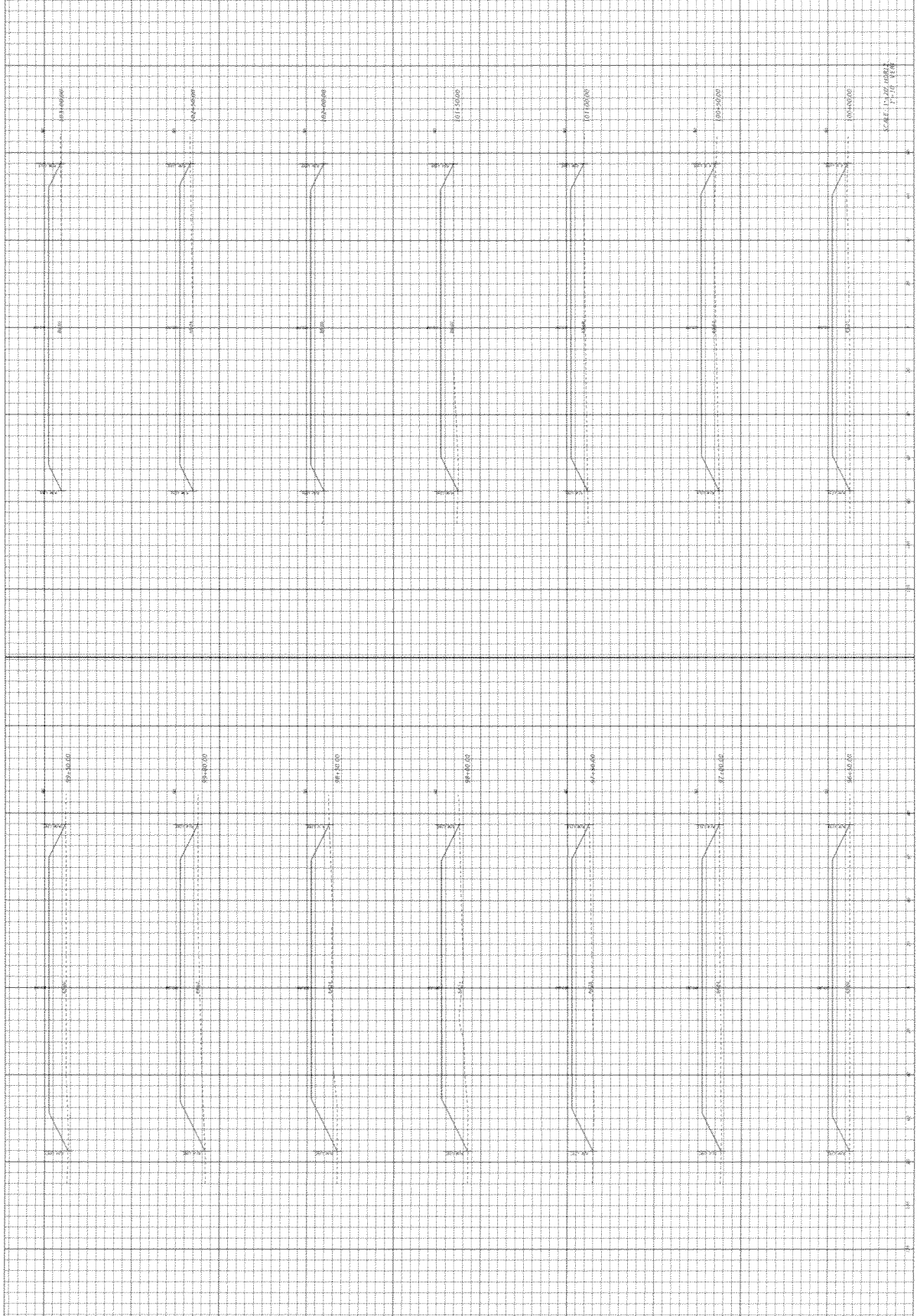

CROSS SECTIONS AT N1/N2 CECIL COMMERCE CENTER



ETM ENGINEERING, TRINITY & TRIMBLE, INC.
10000 W. UNIVERSITY BLVD.
DALLAS, TEXAS 75243
TEL: (214) 343-1234
FAX: (214) 343-1235
WWW.ETM-ENGINEERING.COM

DATE: 3/7/2014
PROJECT: N1/N2
DRAWN BY: JACSON MCGRAW
CHECKED BY: JACSON MCGRAW
SCALE: 1/2" = 1'-0"

MODEL: Bayfield_01g
PLOT DATE: 3/7/2014 3:27:00 PM
BY: jfmh
PROJECT: CECIL COMMERCE CENTER
DRAWING NO: 19

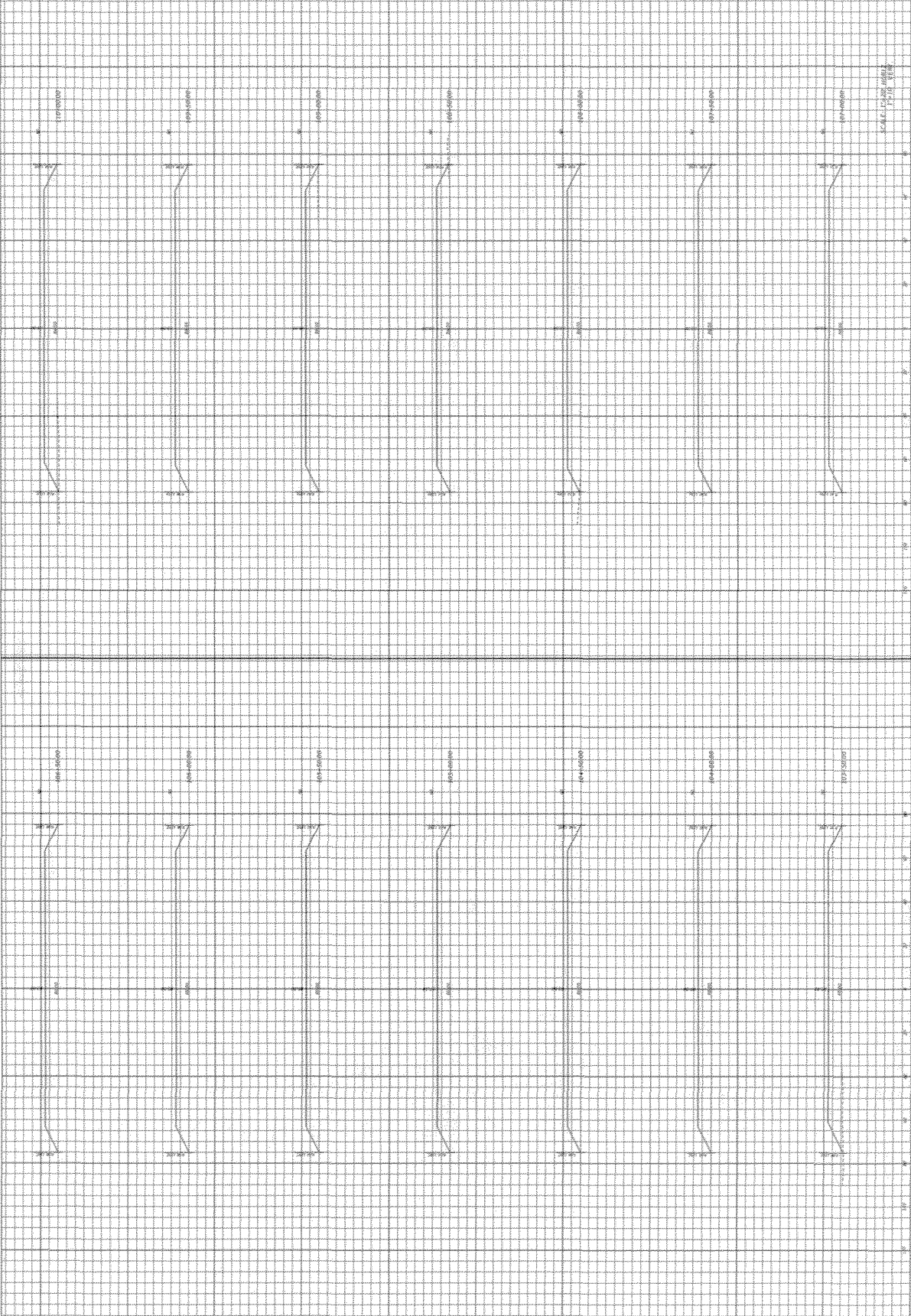

5-12-17\17-1147-01\77\ms\dwg\m17\17\17_1147_01.dwg CLEARNING

20

CROSS SECTIONS

N1/N2
AT

CECIL COMMERCE CENTER



Empire-Tony & Steve, Inc.
1400 N. Highway
Rochester, NY 14610
Telephone: 253-1388
Fax: 253-4122

UNION • EXPERIENCE • RESULTS

MODEL: Rd411.dwg

DATE: 9/7/2014

DRAWN BY: RM

CHECKED BY: RM

DATE: 9/1/2014

PROJECT: CE

SHEET: 20 OF 30

PLANS REQUIRED UNDER THE
SECTION OF
SECTION 17.02
SECTION 17.02

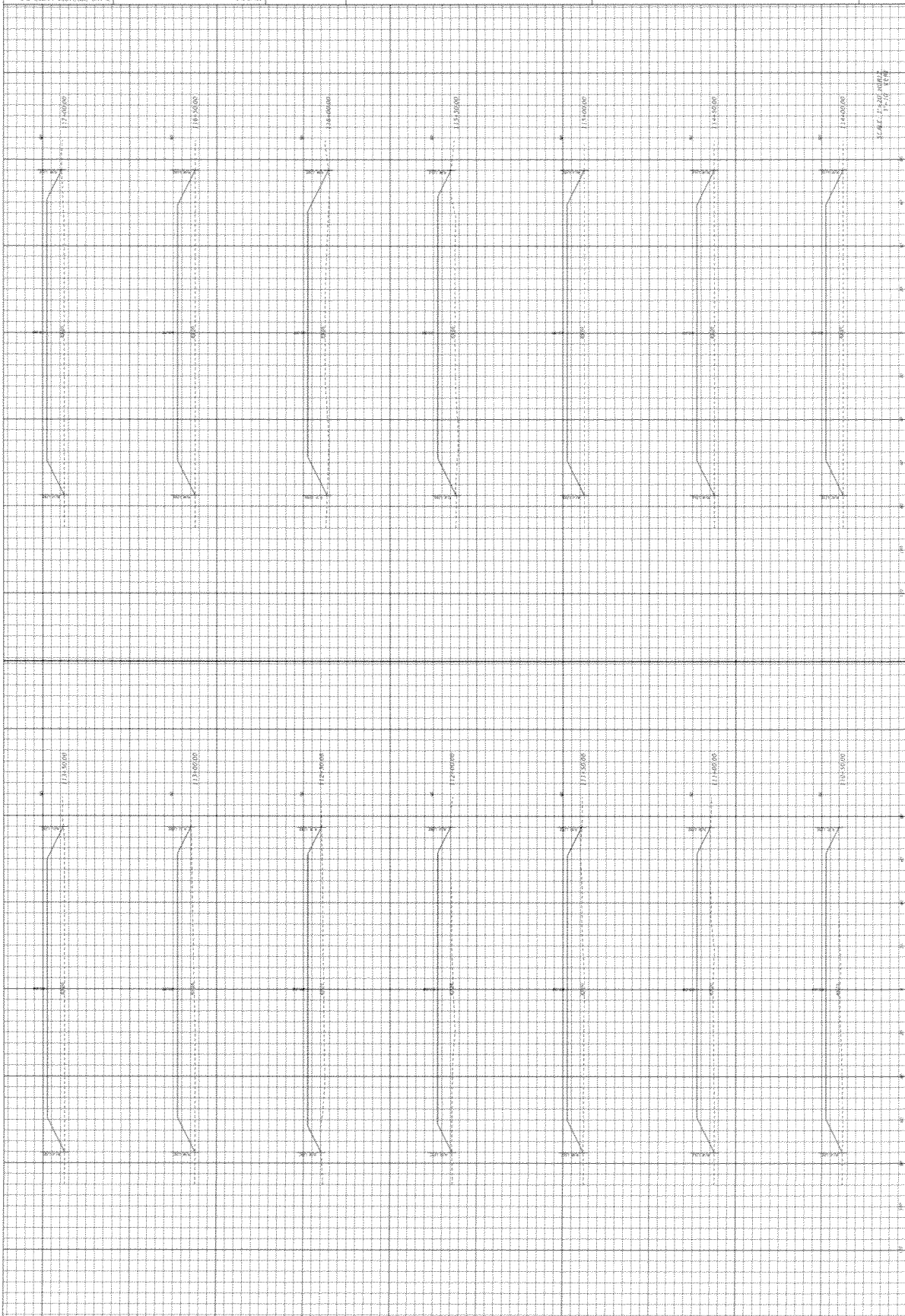

CROSS SECTIONS
AT
N1/N2
CECIL COMMERCE CENTER



ETM
Engineering, Planning & Construction, Inc.
1125 S. Main Street
Tomball, TX 77375
281-353-1111
www.etm.com

DATE	01/25/2018
PROJECT	CECIL COMMERCE CENTER
DRAWN BY	ETM
CHECKED BY	ETM
SCALE	1/8"=1'-0"
SHEET NO.	21

MODEL: *Basild_Bldg*
 PLOTTED: 01/27/2018 3:27:08 PM
 R1 - 01/27/2018
 JASON WISNEY
 PROJECT MANAGER
 PLANNING & CONSTRUCTION, INC.

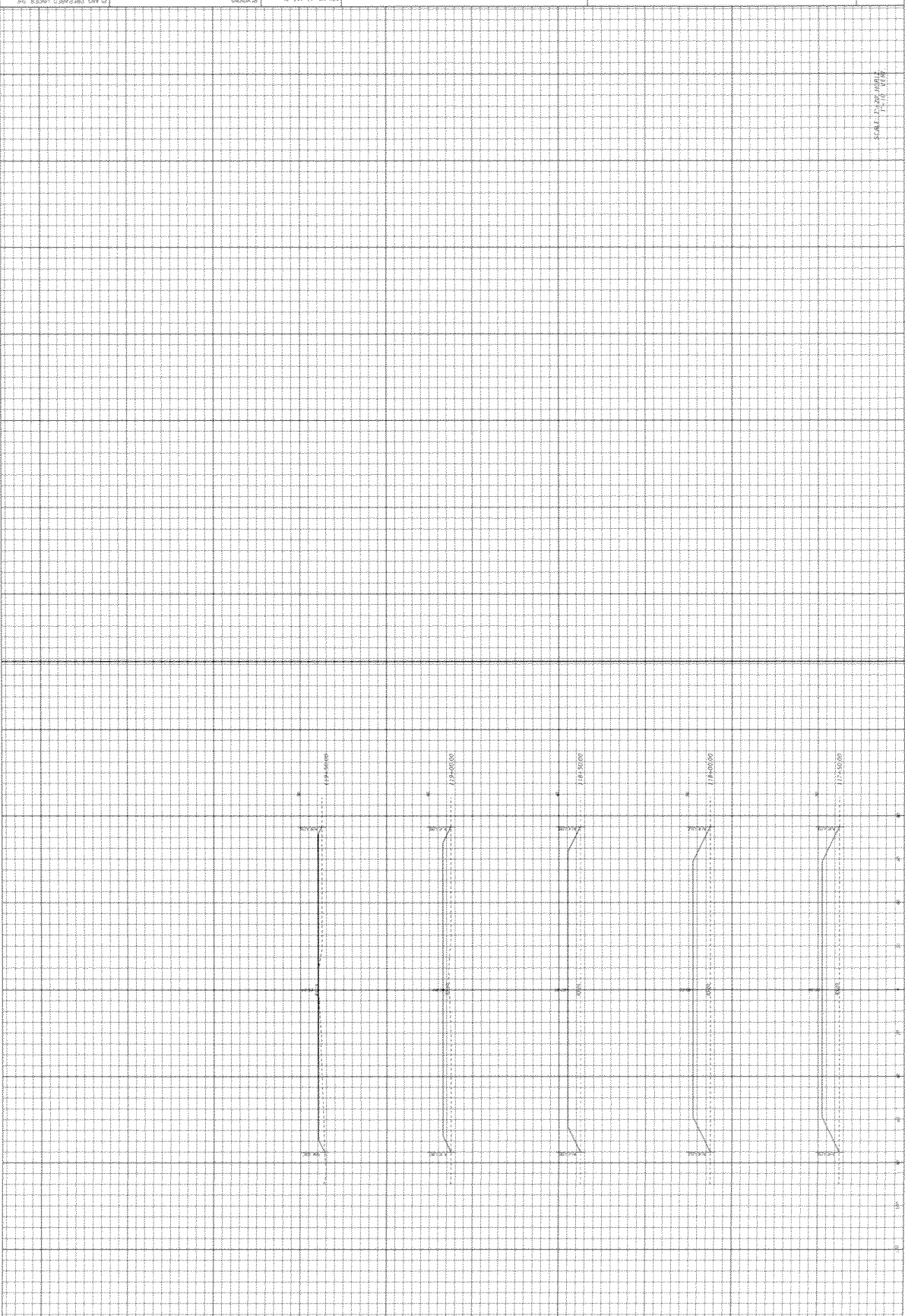

DATE	05/12/2014
PROJECT	CECIL COMMERCE CENTER
SHEET NO.	23
TITLE	SEDIMENT AND EROSION CONTROL DETAILS
SCALE	AS SHOWN
DESIGNED BY	J. [REDACTED]
CHECKED BY	[REDACTED]
DATE	05/12/2014

APP'D BY	[REDACTED]
DATE	05/12/2014

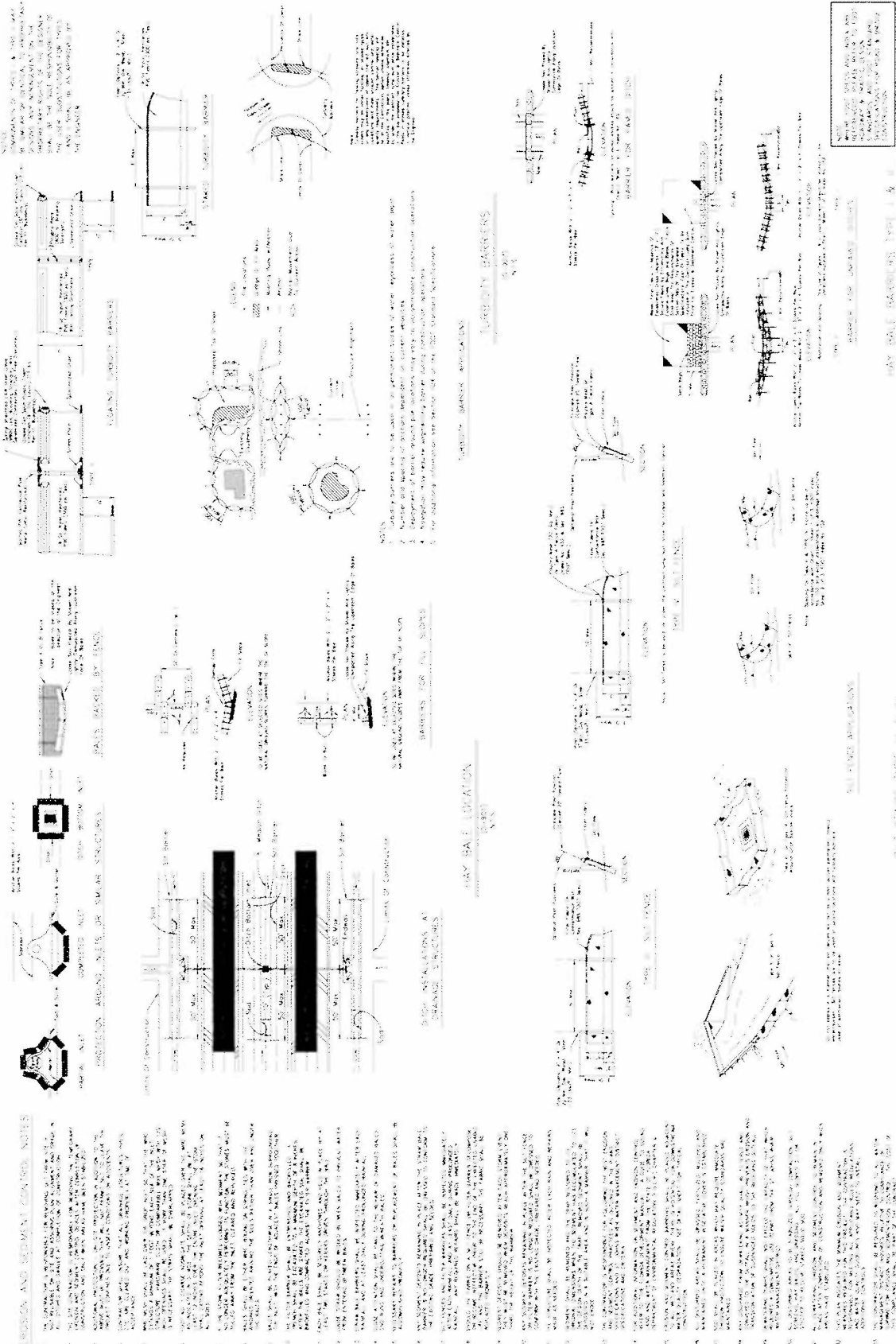

EROSION AND SEDIMENT CONTROL NOTES:

1. ALL EROSION AND SEDIMENT CONTROL STRUCTURES SHALL BE CONSTRUCTED AND MAINTAINED IN ACCORDANCE WITH THE FOLLOWING NOTES AND THE DETAIL DRAWINGS.
2. ALL EROSION AND SEDIMENT CONTROL STRUCTURES SHALL BE CONSTRUCTED USING THE MATERIALS AND METHODS SPECIFIED IN THESE NOTES AND THE DETAIL DRAWINGS.
3. ALL EROSION AND SEDIMENT CONTROL STRUCTURES SHALL BE CONSTRUCTED IN ACCORDANCE WITH THE FOLLOWING NOTES AND THE DETAIL DRAWINGS.
4. ALL EROSION AND SEDIMENT CONTROL STRUCTURES SHALL BE CONSTRUCTED IN ACCORDANCE WITH THE FOLLOWING NOTES AND THE DETAIL DRAWINGS.
5. ALL EROSION AND SEDIMENT CONTROL STRUCTURES SHALL BE CONSTRUCTED IN ACCORDANCE WITH THE FOLLOWING NOTES AND THE DETAIL DRAWINGS.
6. ALL EROSION AND SEDIMENT CONTROL STRUCTURES SHALL BE CONSTRUCTED IN ACCORDANCE WITH THE FOLLOWING NOTES AND THE DETAIL DRAWINGS.
7. ALL EROSION AND SEDIMENT CONTROL STRUCTURES SHALL BE CONSTRUCTED IN ACCORDANCE WITH THE FOLLOWING NOTES AND THE DETAIL DRAWINGS.
8. ALL EROSION AND SEDIMENT CONTROL STRUCTURES SHALL BE CONSTRUCTED IN ACCORDANCE WITH THE FOLLOWING NOTES AND THE DETAIL DRAWINGS.
9. ALL EROSION AND SEDIMENT CONTROL STRUCTURES SHALL BE CONSTRUCTED IN ACCORDANCE WITH THE FOLLOWING NOTES AND THE DETAIL DRAWINGS.
10. ALL EROSION AND SEDIMENT CONTROL STRUCTURES SHALL BE CONSTRUCTED IN ACCORDANCE WITH THE FOLLOWING NOTES AND THE DETAIL DRAWINGS.
11. ALL EROSION AND SEDIMENT CONTROL STRUCTURES SHALL BE CONSTRUCTED IN ACCORDANCE WITH THE FOLLOWING NOTES AND THE DETAIL DRAWINGS.
12. ALL EROSION AND SEDIMENT CONTROL STRUCTURES SHALL BE CONSTRUCTED IN ACCORDANCE WITH THE FOLLOWING NOTES AND THE DETAIL DRAWINGS.
13. ALL EROSION AND SEDIMENT CONTROL STRUCTURES SHALL BE CONSTRUCTED IN ACCORDANCE WITH THE FOLLOWING NOTES AND THE DETAIL DRAWINGS.
14. ALL EROSION AND SEDIMENT CONTROL STRUCTURES SHALL BE CONSTRUCTED IN ACCORDANCE WITH THE FOLLOWING NOTES AND THE DETAIL DRAWINGS.
15. ALL EROSION AND SEDIMENT CONTROL STRUCTURES SHALL BE CONSTRUCTED IN ACCORDANCE WITH THE FOLLOWING NOTES AND THE DETAIL DRAWINGS.
16. ALL EROSION AND SEDIMENT CONTROL STRUCTURES SHALL BE CONSTRUCTED IN ACCORDANCE WITH THE FOLLOWING NOTES AND THE DETAIL DRAWINGS.
17. ALL EROSION AND SEDIMENT CONTROL STRUCTURES SHALL BE CONSTRUCTED IN ACCORDANCE WITH THE FOLLOWING NOTES AND THE DETAIL DRAWINGS.
18. ALL EROSION AND SEDIMENT CONTROL STRUCTURES SHALL BE CONSTRUCTED IN ACCORDANCE WITH THE FOLLOWING NOTES AND THE DETAIL DRAWINGS.
19. ALL EROSION AND SEDIMENT CONTROL STRUCTURES SHALL BE CONSTRUCTED IN ACCORDANCE WITH THE FOLLOWING NOTES AND THE DETAIL DRAWINGS.
20. ALL EROSION AND SEDIMENT CONTROL STRUCTURES SHALL BE CONSTRUCTED IN ACCORDANCE WITH THE FOLLOWING NOTES AND THE DETAIL DRAWINGS.

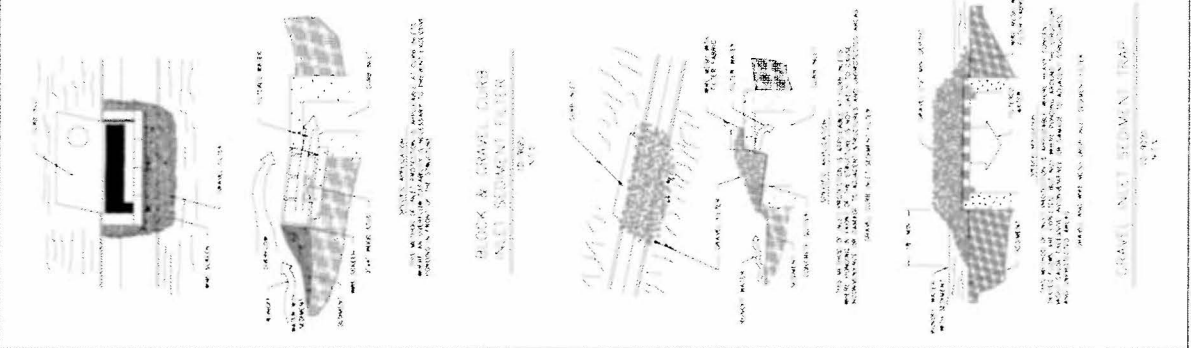
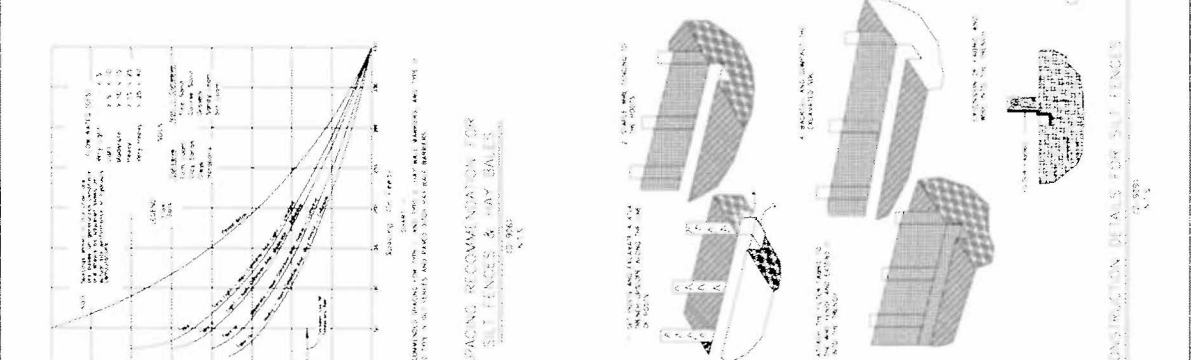
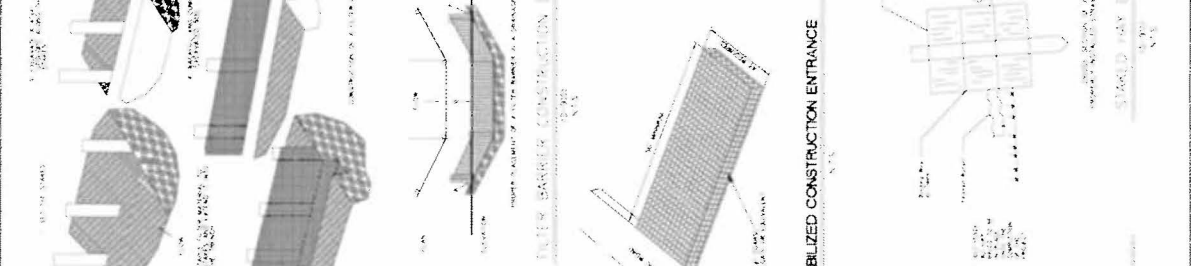



OFFICE OF ECONOMIC DEVELOPMENT
OFFICE OF MAYOR ALVIN BROWN
JACKSONVILLE, FL

TO: Greg Pease, Chairman, Professional Services Evaluation Committee
FROM:  Ed Randolph, Cecil Commerce Center Manager
SUBJECT: VT Griffin Services, Inc. Contract (No. 7846-02) Amendment Number Two (2)
DATE: June 23, 2014

OED requests authorization to increase the maximum indebtedness of the subject contract by \$973,467.71, to a new maximum indebtedness to the City of \$2,403,395.69. The proposed increase will allow the OED to perform some brush clearing and future road improvements, on City-owned property at Cecil Commerce Center. It will also allow for the OED to make improvements to a city-owned building, for future use by a tenant.

Accordingly, this is to recommend that Contract No. 7846-02 between the City of Jacksonville and VT Griffin, for the Management and Maintenance/Caretaker Support Services for Cecil Commerce Center be amended by: (i) incorporating the attached scope of services and cost proposal identified as Exhibit "C"; (ii) providing a not-to-exceed maximum indebtedness to the City of \$2,403,395.69. All other terms and conditions are per the city's standard contract language. Nothing contained herein shall be amended, modified, or otherwise revised without prior approval from PSEC and the Mayor.

Please contact Ed Randolph, at 630-1185, if you have any questions concerning this matter.

Thank you for your assistance.

VT Griffin
6112 New World Avenue
Jacksonville, FL 32221

Tel 904.777.1900
Fax 904.777-0097



June 23, 2014

Mr. Edward W. Randolph, Cecil Commerce Center Manager
Office of Economic Development
117 West Duval Street, Suite 275
Jacksonville, Florida 32202

Re: RFP P-16-13/City Contract No. 7846-02
Agreement between the City of Jacksonville and VT Griffin;
Management and Maintenance/Caretaker Support at Cecil Commerce Center
Request for Proposal, Contract Amendment; Additional Funding

Dear Mr. Randolph:

In response to your request for proposal for N1/N2 Road Construction, the attached proposal is forwarded. We have summarized the proposed changes on the enclosed summary sheet to add an additional \$973,467.71 in funding to the "Over & Above" annex for clearing area and developing a new entrance to parcels N1/N2. Award is based on base bid plus items 1, 2, and 3.

Should you have any questions, please do not hesitate to call me at (904) 777-1900, extension 11.

Thank you.

Sincerely,

A handwritten signature in black ink, appearing to read "James D. Jelsma".

James D. Jelsma, CGC 061080
VT Group
Project Manager

JDJ/ss

Enclosure (1)



OVER AND ABOVE AWARD REQUEST

TO: ED RANDOLPH
FROM: JAMES JELSMA
DATE: 6/23/2014

Over and Above Funding Request contract P16-13

#	Firm	Contract Amount	6.5% G&A	5.0% Management	Total w/GAM
1	Hager Construction Company	\$870,527.80	\$56,584.31 \$927,112.11	\$46,355.61 \$973,467.71	\$973,467.71
2	.				
3					
4					
	Subtotal Over and above Request				\$973,467.71

Mr. Randolph,

Per your request,
Attached is the most responsive and responsible proposal. Contract requires 25% of contracts to be awarded to JSEB qualified firms. Hager Construction is an Active JSEB . We are proud to acknowledge 100% of the funding requested is to a JSEB firm verified in good standing.

AWARD IS BASED ON BASE BID PLUS ADDITIVE ITEMS 1, 2, &3.

CLEAR AREA AND DEVELOP NEW ENTRANCE ROAD TO

PARCELS N-1 AND N-2 CECIL COMMERCE CENTER JACKSONVILLE, FLORIDA



Office of Economic
Development

Cecil Commerce Center
Jacksonville, Florida

Future Spec Site

April 7, 2014



ETM
Environmental Technology
Map Information Services

Note: This map was prepared for the purpose of providing a visual representation of the site. It is not intended to be used as a legal document. The information contained herein is for informational purposes only and should not be relied upon for any legal or financial decision. The information is provided "as is" without any warranty, express or implied. The user assumes all responsibility for the use of this information.