

FLORIDA DEPARTMENT OF NATURAL RESOURCES  
STANDARD LANGUAGE FOR PROPERTY RECORDS  
FLORIDA RECREATION DEVELOPMENT ASSISTANCE PROGRAM

Notice of Limitation of Use/Site Dedication

The property identified in the attached project agreement and boundary map has been acquired or developed by the project sponsor with financial assistance provided by the Florida Department of Natural Resources (DNR) in accordance with Chapter 16D-5, Part V, Florida Administrative Code. Pursuant to requirements of that rule, land either already owned and then developed or land acquired by the project sponsor with grant assistance shall be dedicated in perpetuity as an outdoor recreation area for the use and benefit of the general public. Leased land developed by the project sponsor with program assistance shall be dedicated as an outdoor recreation area for the general public for a minimum of twenty-five (25) years after completion of development. If the project sponsor should convert any part of the project area or the facilities thereon, whether acquired or developed with grant assistance, to other than DNR approved recreational uses, the project sponsor shall replace the area and facilities at its own expense with a DNR approved project of comparable or greater scope and quality, adjacent to or in near proximity to the original project. In lieu of such replacement, DNR may require return of grant funds disbursed to the project sponsor. FRDAP grant funds shall be refunded with interest, calculated at two (2) percent over the prevailing prime rate as reported by the Federal Reserve.

I certify that copies of the Notice of Limitation of Use/Site Dedication form, project agreement and project boundary map have been filed in the County Courthouse with the deed to the property on which the following grant project is located:

Metropolitan Park Annex F84-001/F85-012

FRDAP Project Name and Number

*Daniel Weimer*

Signature of Liaison Agent.

Daniel Weimer, Chief  
Planning, Research and Grants

Typed Name and Title

*10/31/88*

Date

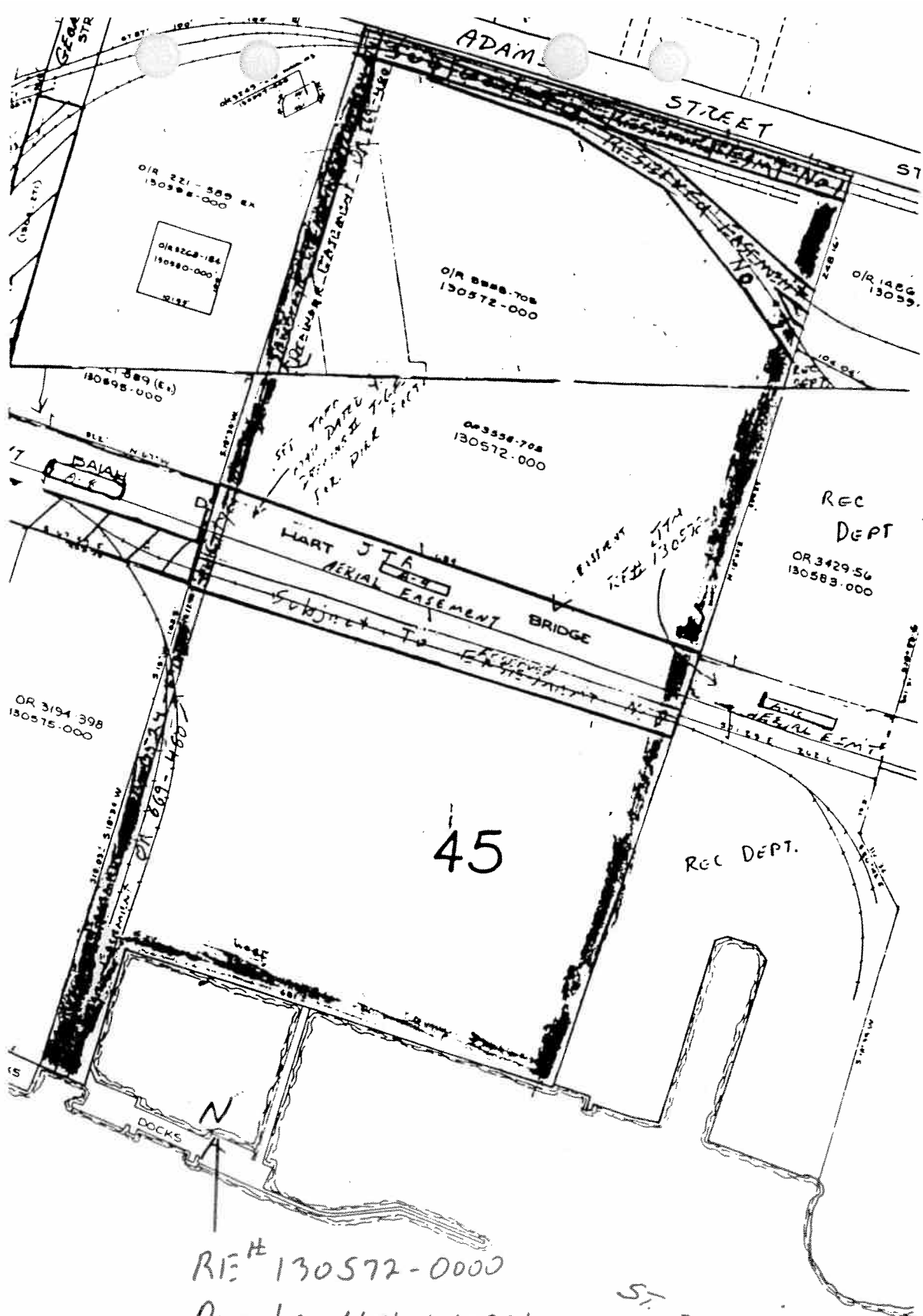

RI: # 130572-0000  
 PARCELS 401 + 404  
 SCALE 1" = 150'

ST. JOHNS RIVER